

KOI

Decken-Pendelleuchte, Bogenlampe
Suspended light fixture, Arc lamps
Lampe suspendue, Lampadaire incurvé
Pendellamp, Booglamp
Apparecchio a sospensione, Lampadina

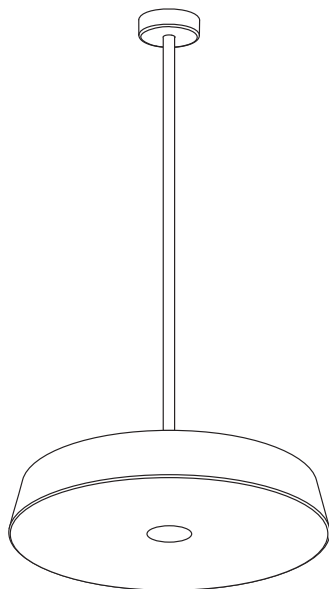

Montageanleitung
Assembly Instructions
Instruction de montage
Montagehandleiding
Istruzioni di montaggio

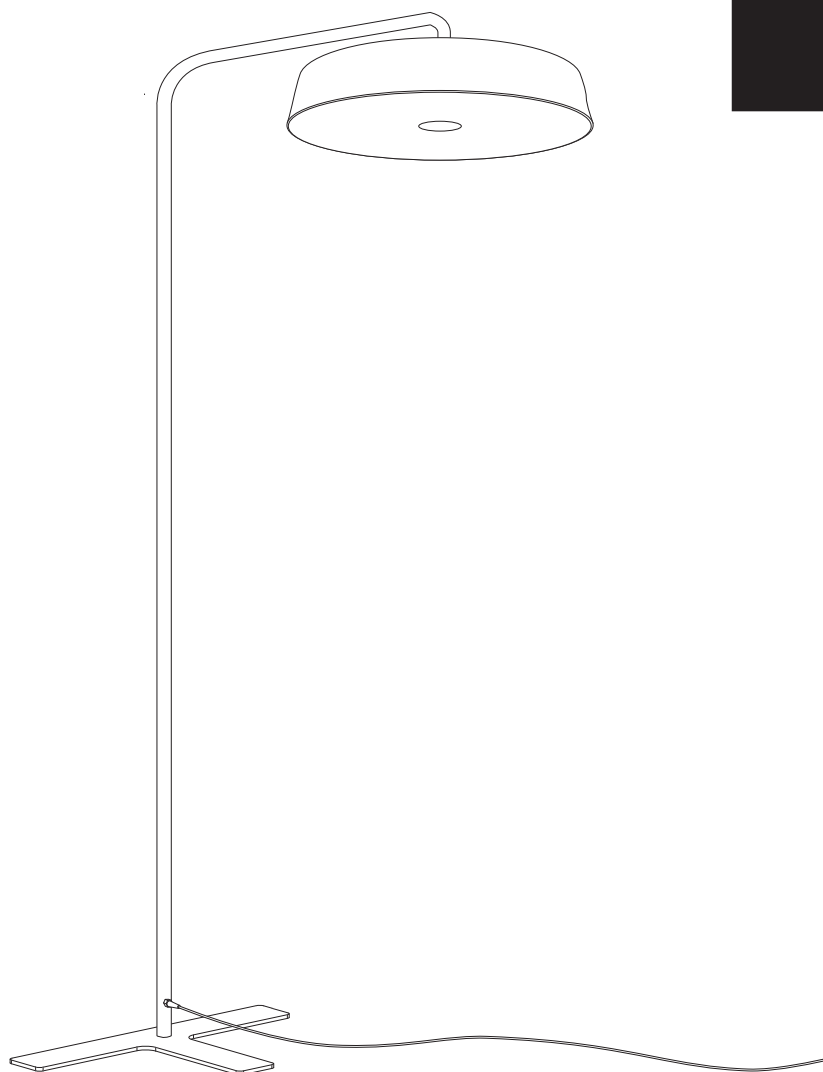

KOI Pendelleuchte

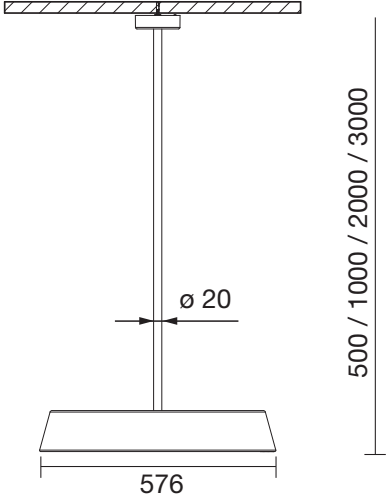

KOI Bogenlampe

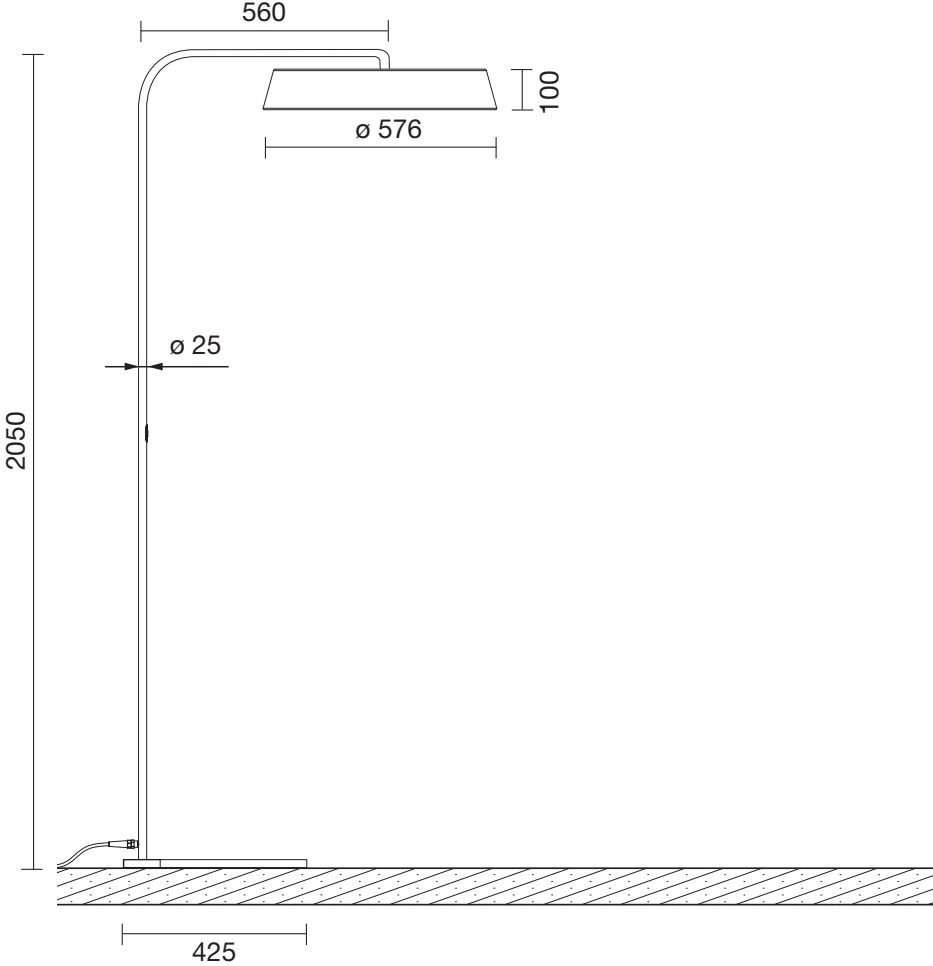

Technische Hinweise

Technical Information

Indications techniques



- Bei Montage, Reinigung, Wartungsarbeiten und Leuchtmittelwechsel immer Stromzufuhr unterbrechen.

- When executing an assembly, cleaning, maintenance works or when changing the bulbs always interrupt the power supply by unplugging the power supply cable!

- Lors de montages, du nettoyage, de travaux de maintenance ou de remplacements de sources lumineuses, veuillez à toujours interrompre l'alimentation en retirant la fiche de la prise de courant!



- Eingangsspannung 220-240V 50/60Hz

- Input voltage 220-240V 50/60Hz

- Tension d'entrée 220-240V 50/60Hz



- Leuchtmittel TC-TE 42W/840

- Lamp TC-TE 42W/840

- Ampoule TC-TE 42W/840



- Leuchten nur mit handelsüblichen, nicht aggressiven Reinigungsmitteln reinigen

- Use only commercially available non-aggressive cleaning agents for cleaning the lamps

- Ne nettoyer les lampes qu'avec des nettoyeurs non agressifs en vente dans le commerce

- Bitte reinigen Sie die Abdeckung ausschliesslich mit Wasser oder einem antistatischen Tuch. Alkohol, Benzol, Aceton oder Säuren können die Oberfläche beschädigen.

- Please clean the cover with water only or with an antistatic cloth. Alcohol, benzol, acetone or acids can damage the surface.

- Nettoyer le couvercle de recouvrement uniquement avec de l'eau ou un chiffon antistatique. L'utilisation d'alcool, de benzène, d'acétone ou d'acides peut endommager la surface.



- Leuchte darf nicht im Freien verwendet werden

- Lamp must not be used in the open

- Ne pas utiliser la lampe à l'extérieur



- Schutzklasse I

- Safety class I

- Classe de protection I



- Technische Konformität gemäss EN-Richtlinien

- Technical conformity according to European Standard guidelines

- Conformité technique selon les directives EN

Technische aanwijzingen

Informazioni tecniche



- Bij de montage, de reiniging, de onderhoud en het wisselen van het lichtmiddel altijd de stroomtoevoer onderbreken door trekken van de stekker uit het stopcontact!



- Ingangsspanning 220-240V 50/60Hz



- Lamp TC-TE 42W/840



- Reinig de lampen uitsluitend met normale in de handel verkrijgbare, niet agressieve reinigingsproducten
- De afdekking uitsluitend reinigen met water of een antistatische doek. Alcohol, benzeen, aceton of zuren kunnen het oppervlak beschadigen.

- **Interrompere sempre la corrente elettrica, estraendo la spina dalla presa, in fase di montaggio, di pulizia o in occasione di interventi di manutenzione e sostituzione dei corpi luminosi!**

- Tensione di alimentazione 220-240V 50/60Hz

- Lampadina TC-TE 42W/840

- Pulire la lampada solamente con i normali detersivi non aggressivi che si trovano in commercio

- Pulire il corpo lampada solo con un panno antistatico. Alcool, acetone o altri agenti aggressivi possono danneggiare la superficie.



- De lamp mag niet in openlucht gebruikt worden

- La lampada non può essere utilizzata all'aperto



- Beschermingsklasse I

- Classe di protezione I



- Technische gelijkvormigheid volgens EN-richtlijnen

- Conformità tecnica secondo le Direttive EN

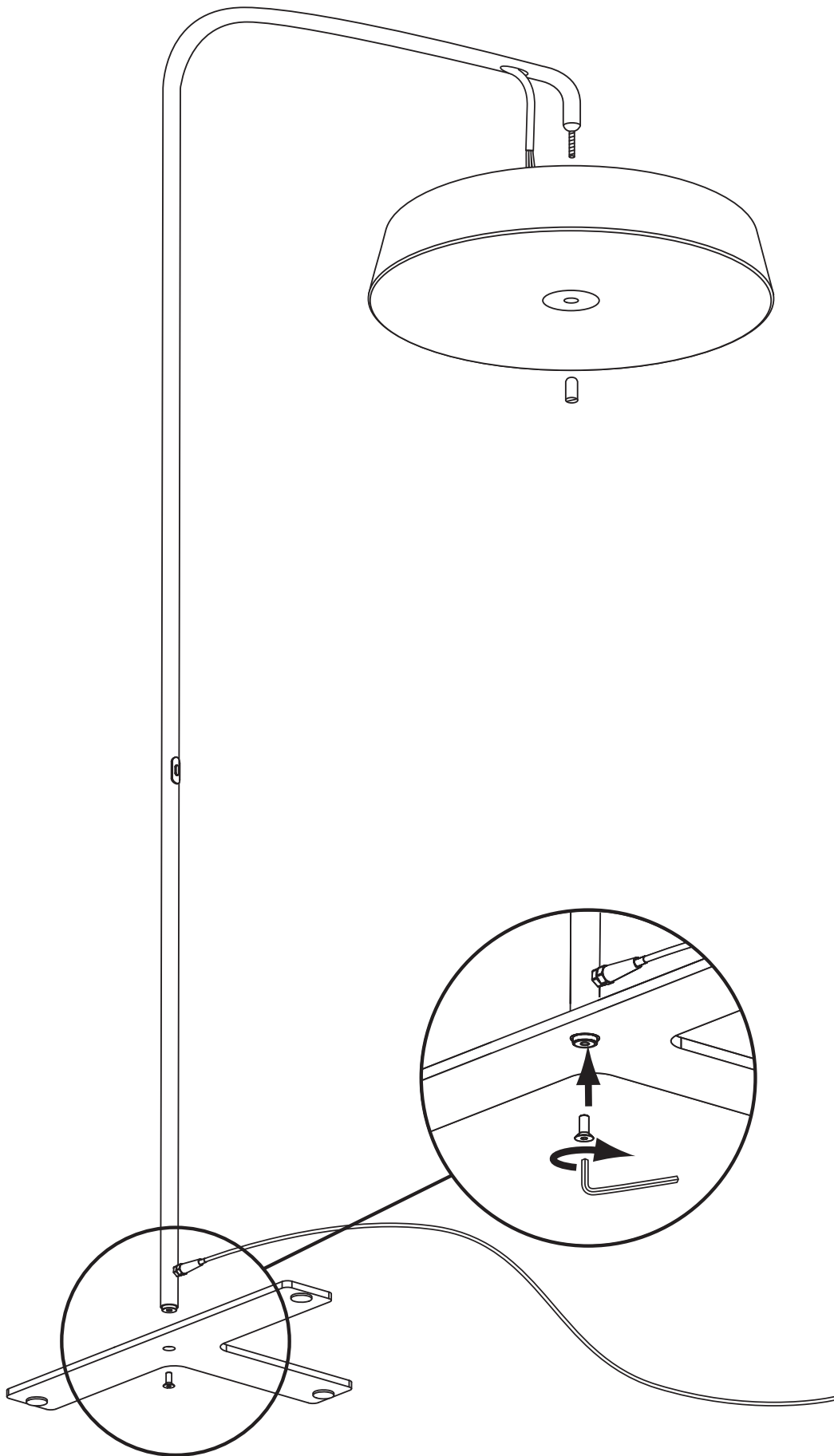

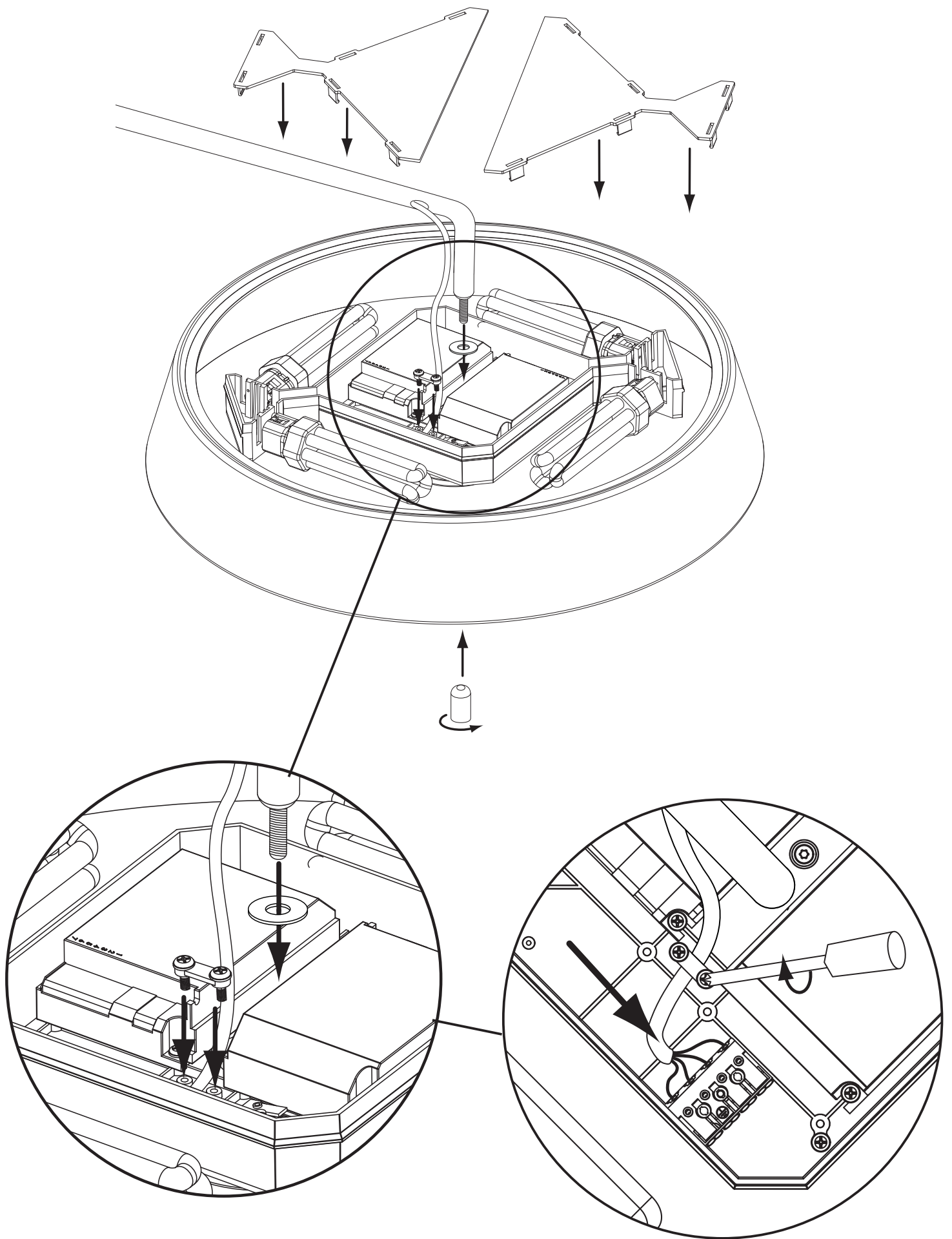

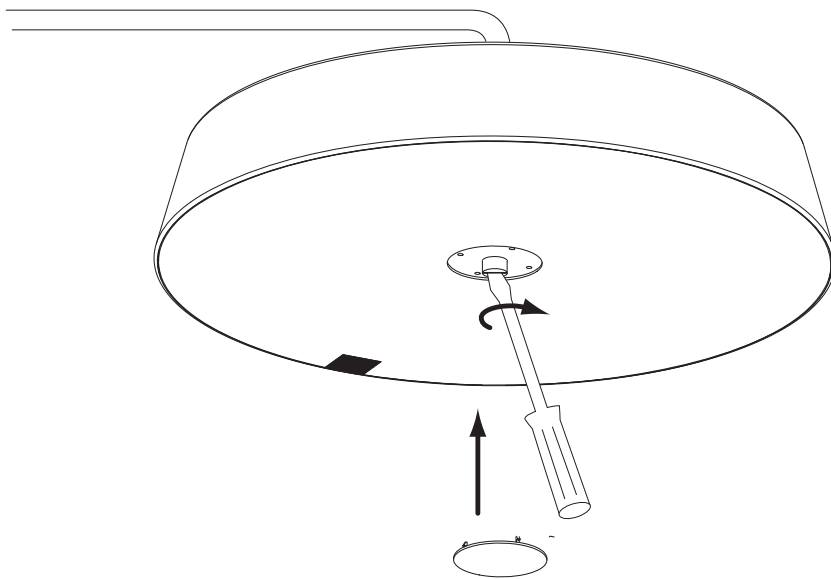
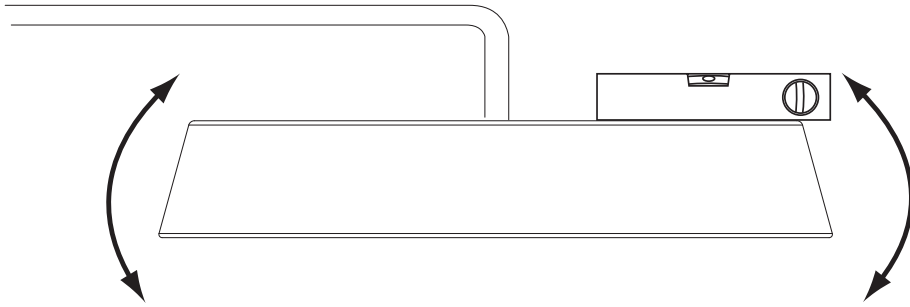
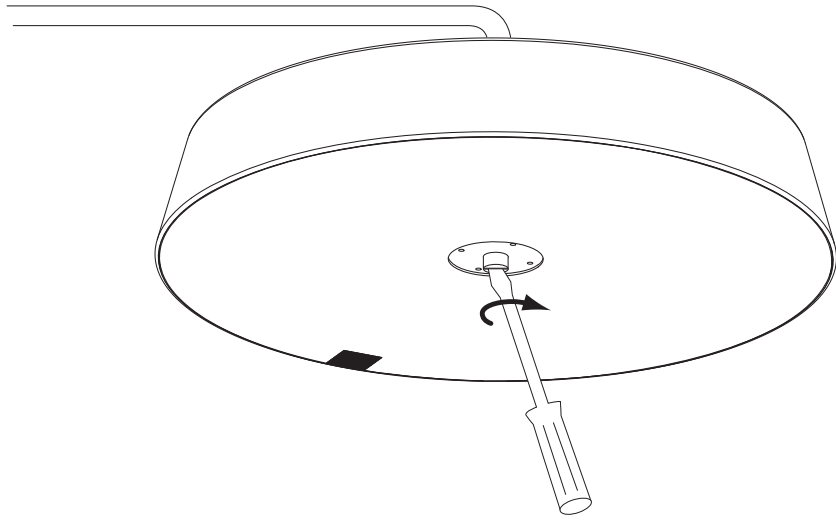

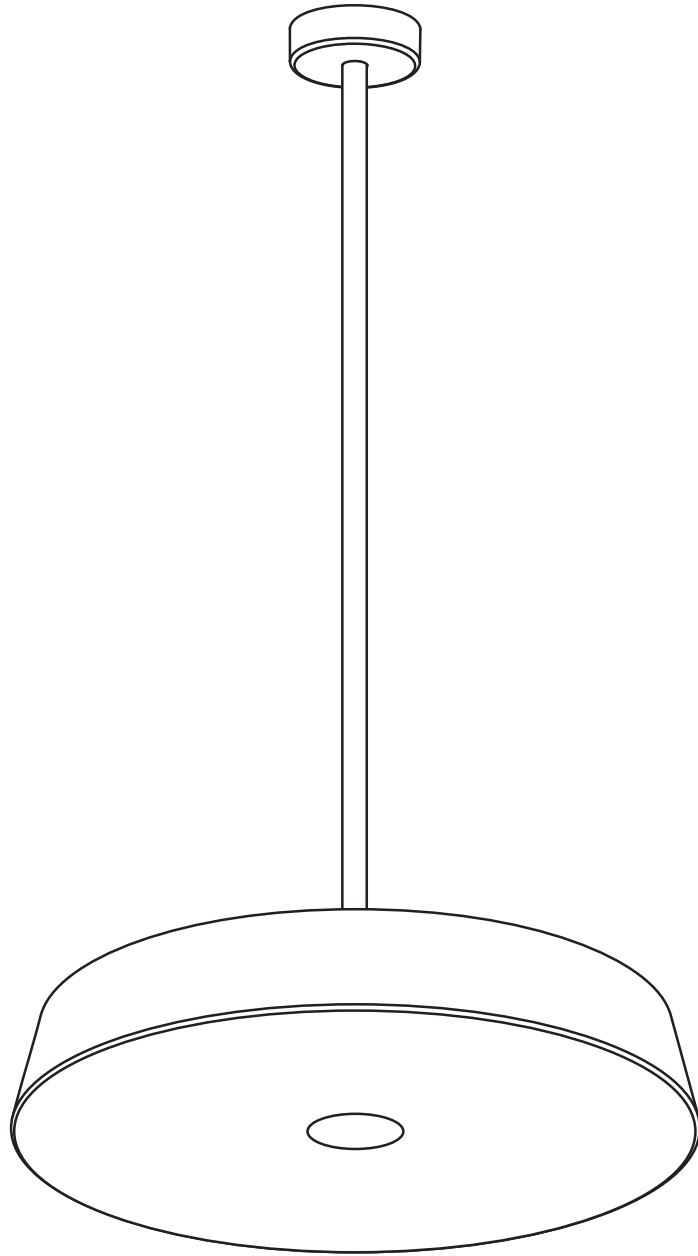

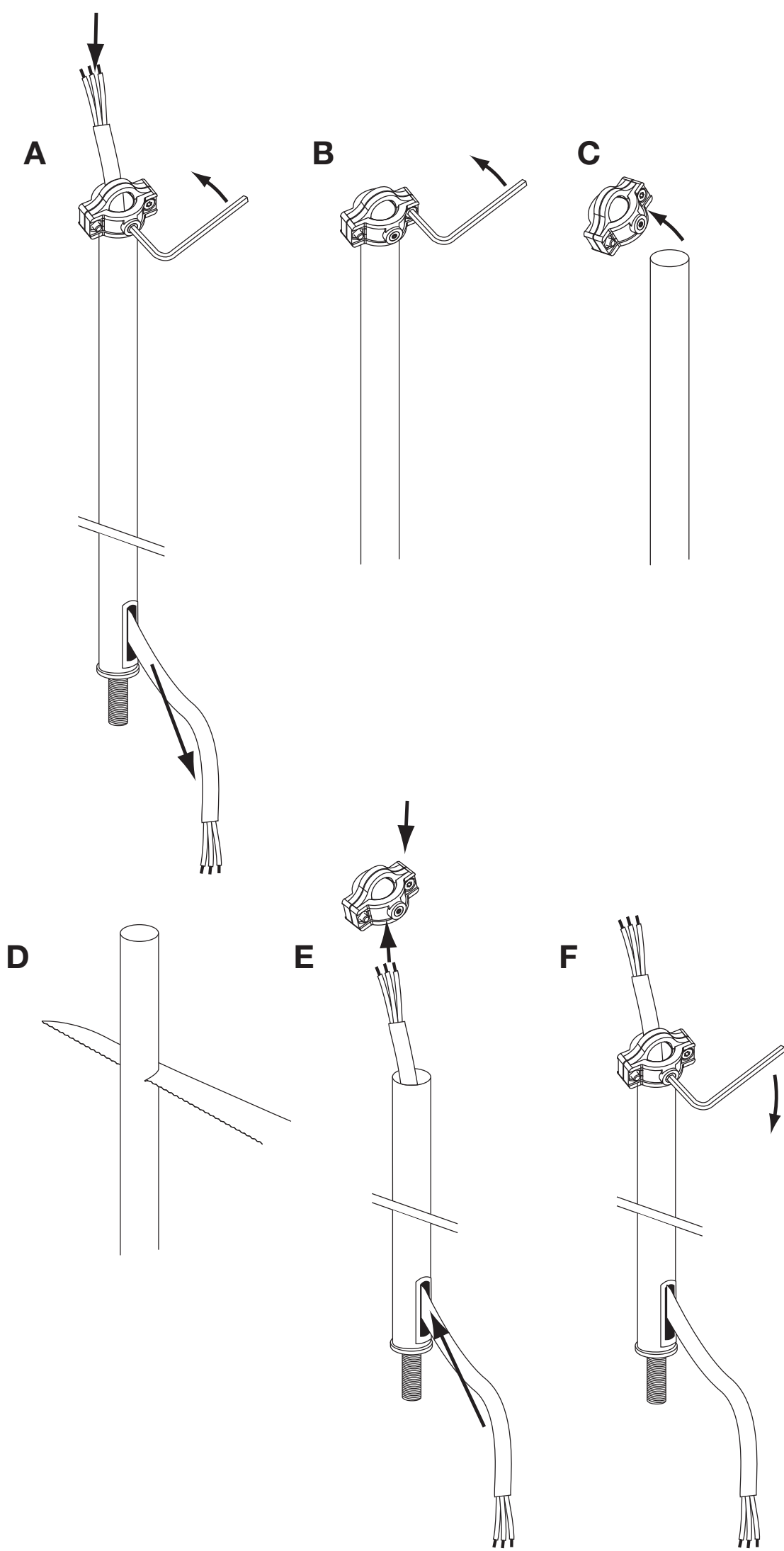

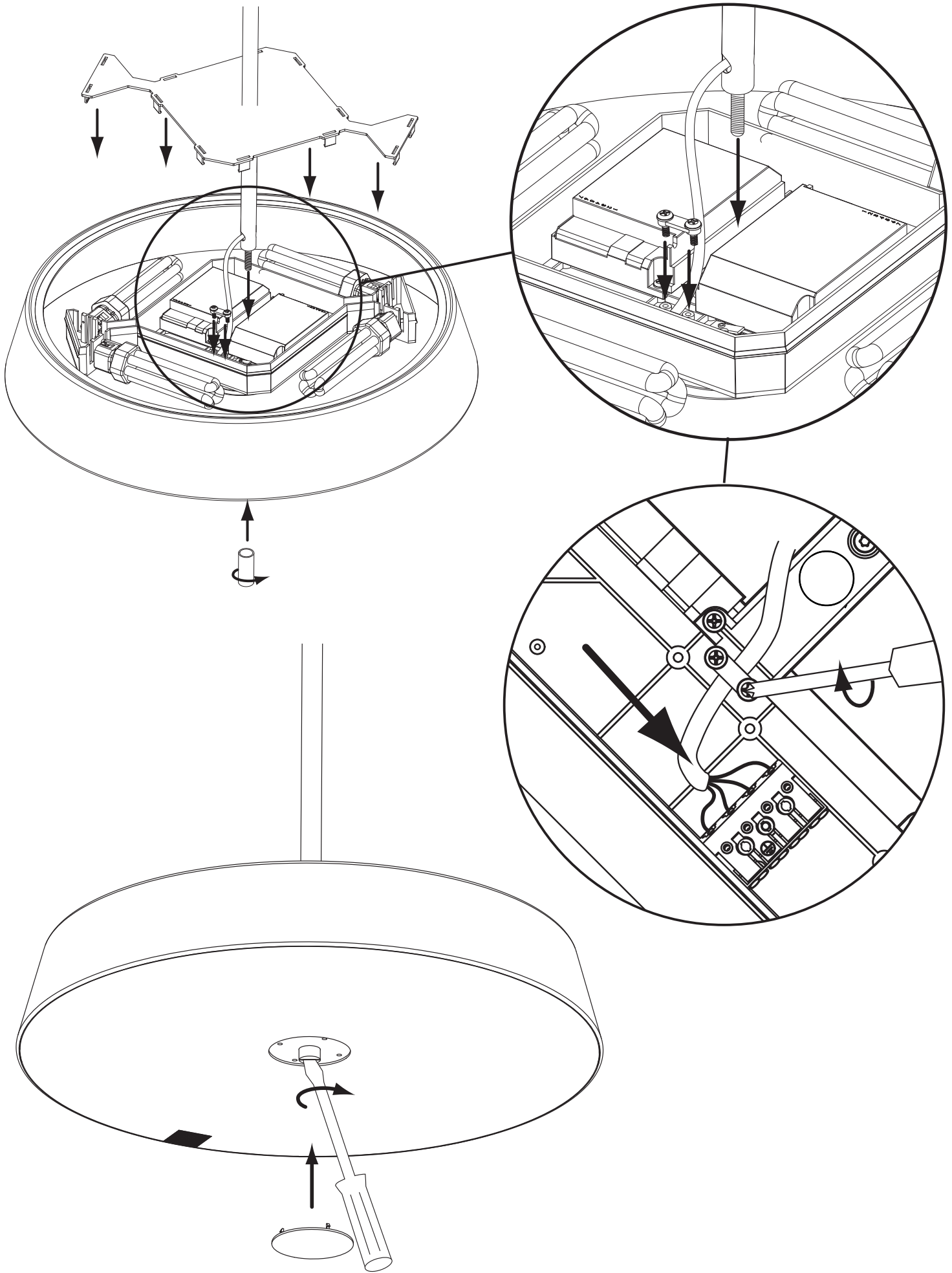

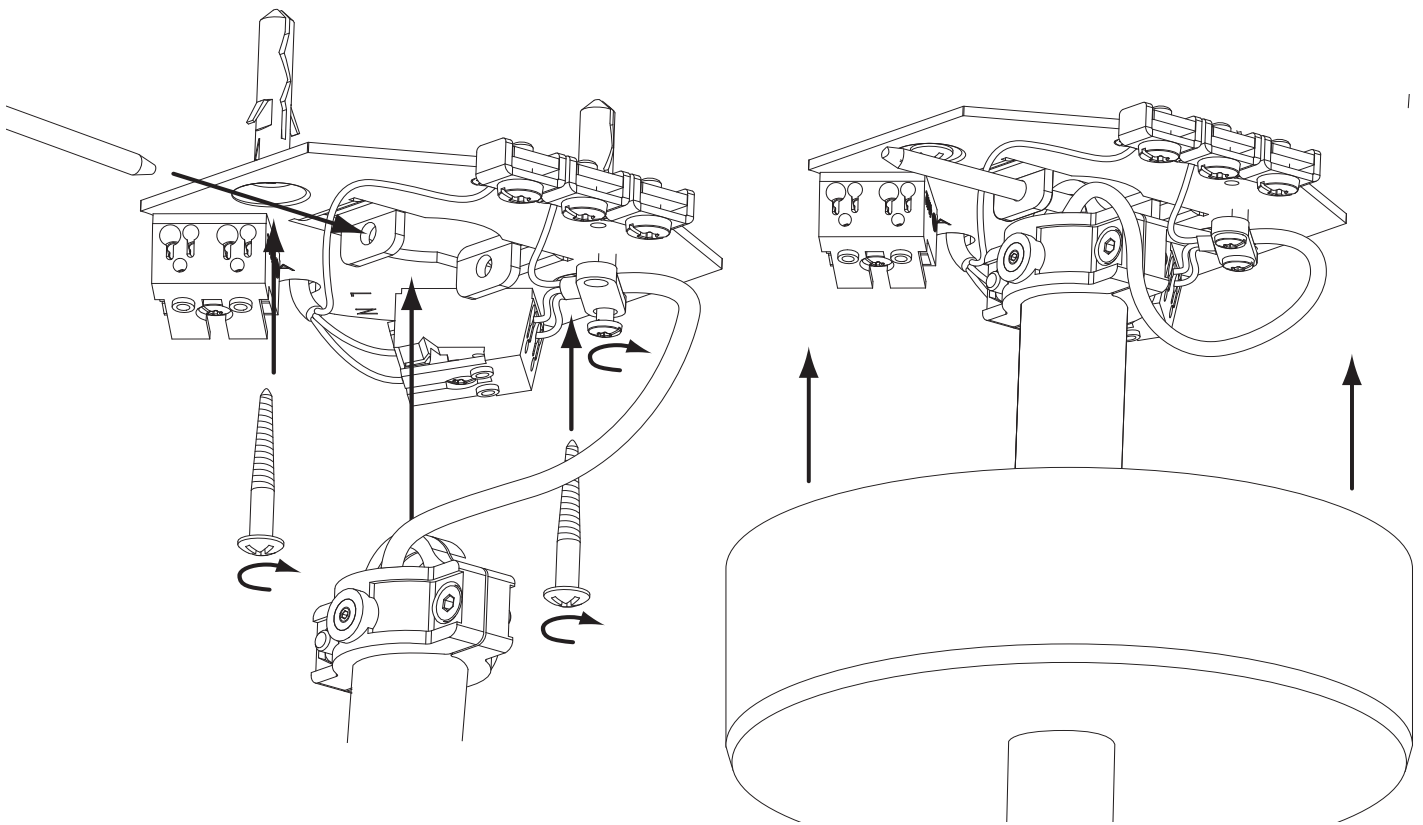

Multisens

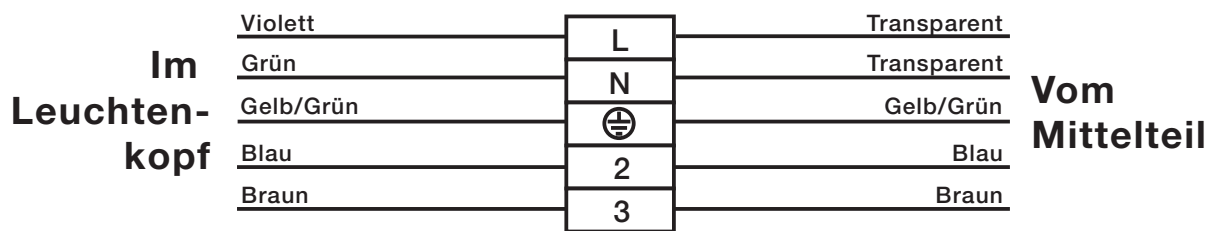

3 Pole

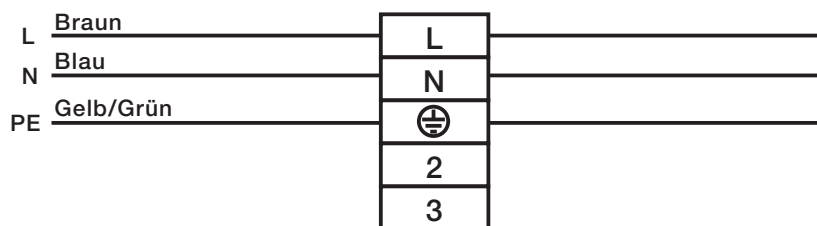
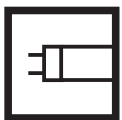

4/5 Pole Touchdim

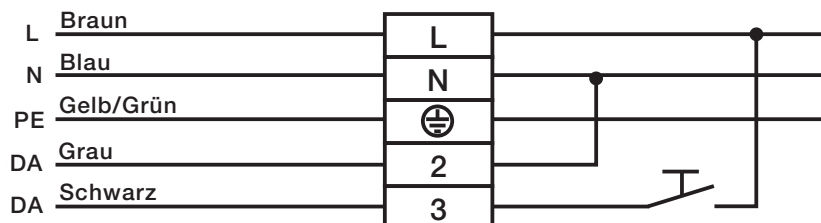
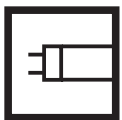

5 Pole DALI

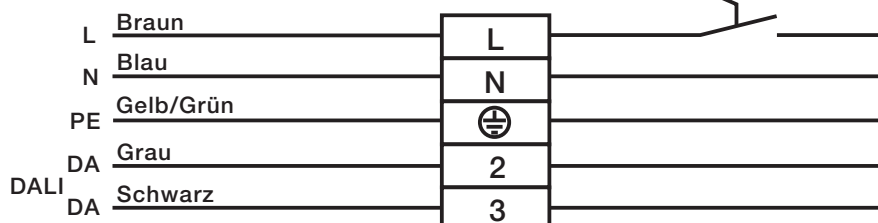
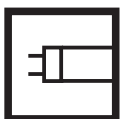



BELUX AG
www.belux.com